

TITLE PLAN	EDITION 1	TP967917L
-------------------	------------------	------------------

LOCATION OF LAND PARISH KEELBUNDORA TOWNSHIP - SECTION - CROWN ALLOTMENT - CROWN PORTION 13 (PART) LAST PLAN REFERENCE LP8482 DEPTH LIMITATION DOES NOT APPLY TITLE REFERENCE VOL.12085 FOL.364 MGA CO-ORDINATES E 323 410 (APPROX. CENTRE OF LAND IN PLAN) N 5 825 700 ZONE 55	WARNING THIS PLAN REPRESENTS AN EXPECTED DIVISION OF LAND. ANY ONE LOT MAY NOT HAVE BEEN CREATED. CHECK THE LOT/PLAN INDEX FOR CURRENT INFORMATION. NOTATIONS THIS PLAN IS NOT BASED ON SURVEY.
---	--

EASEMENT INFORMATION

LEGEND E- ENCUMBERING EASEMENT OR CONDITION IN CROWN GRANT IN THE NATURE OF AN EASEMENT OR OTHER ENCUMBRANCE
 A- APPURTENANT EASEMENT R- ENCUMBERING EASEMENT (ROAD)

EASEMENT REFERENCE	PURPOSE	WIDTH (METRES)	ORIGIN	LAND BENEFITED/IN FAVOUR OF
E-1	AS PROVIDED FOR IN SEC.207C LGA 1989	SEE DIAGRAM	SEC.207C LGA 1989	YARRA VALLEY WATER

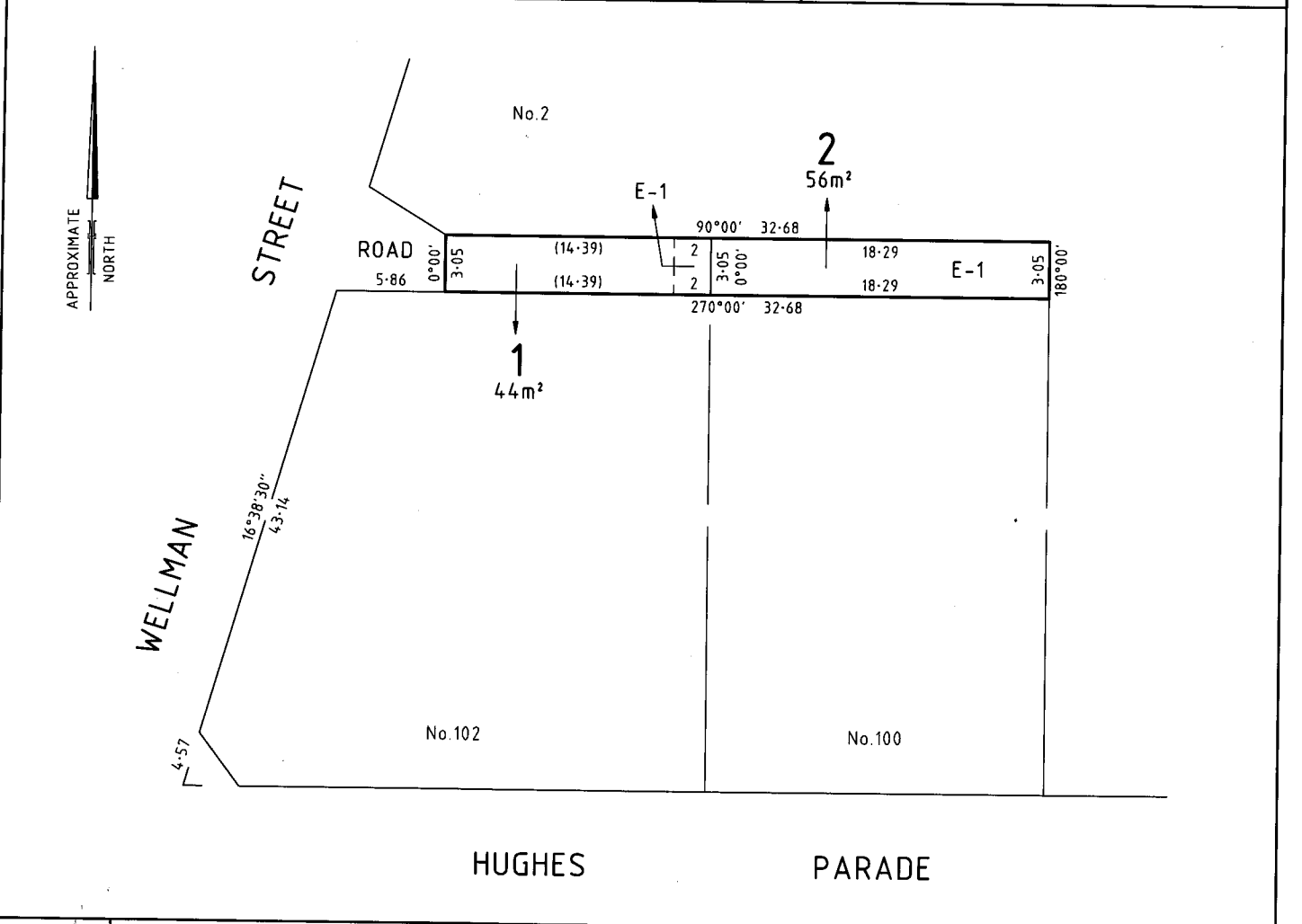

SCALE 1:250	LENGTHS ARE IN METRES	LICENSED SURVEYOR ANDREW CLINTON SMITH SIGNATURE DATE / /	FILE NO : LGD DEALING CODE : LGA
SHEET 1 OF 1 SHEET ORIGINAL SHEET SIZE: A3		REF. 194.04 VERSION 01 COMPUTER FILE: 19404TP.DWG DATE: 09/10/2019	
BARKER MONAHAN A DIVISION OF TERRAIN CONSULTING GROUP PTY LTD SURVEYORS, DEVELOPMENT AND LOCAL GOVERNMENT CONSULTANTS 581 GILBERT ROAD, PRESTON 3072 P.O. BOX 2546 REGENT WEST 3072 TELEPHONE 9478 6133 FAX 9470 5189 EMAIL: survey@barkermonahan.com.au			