

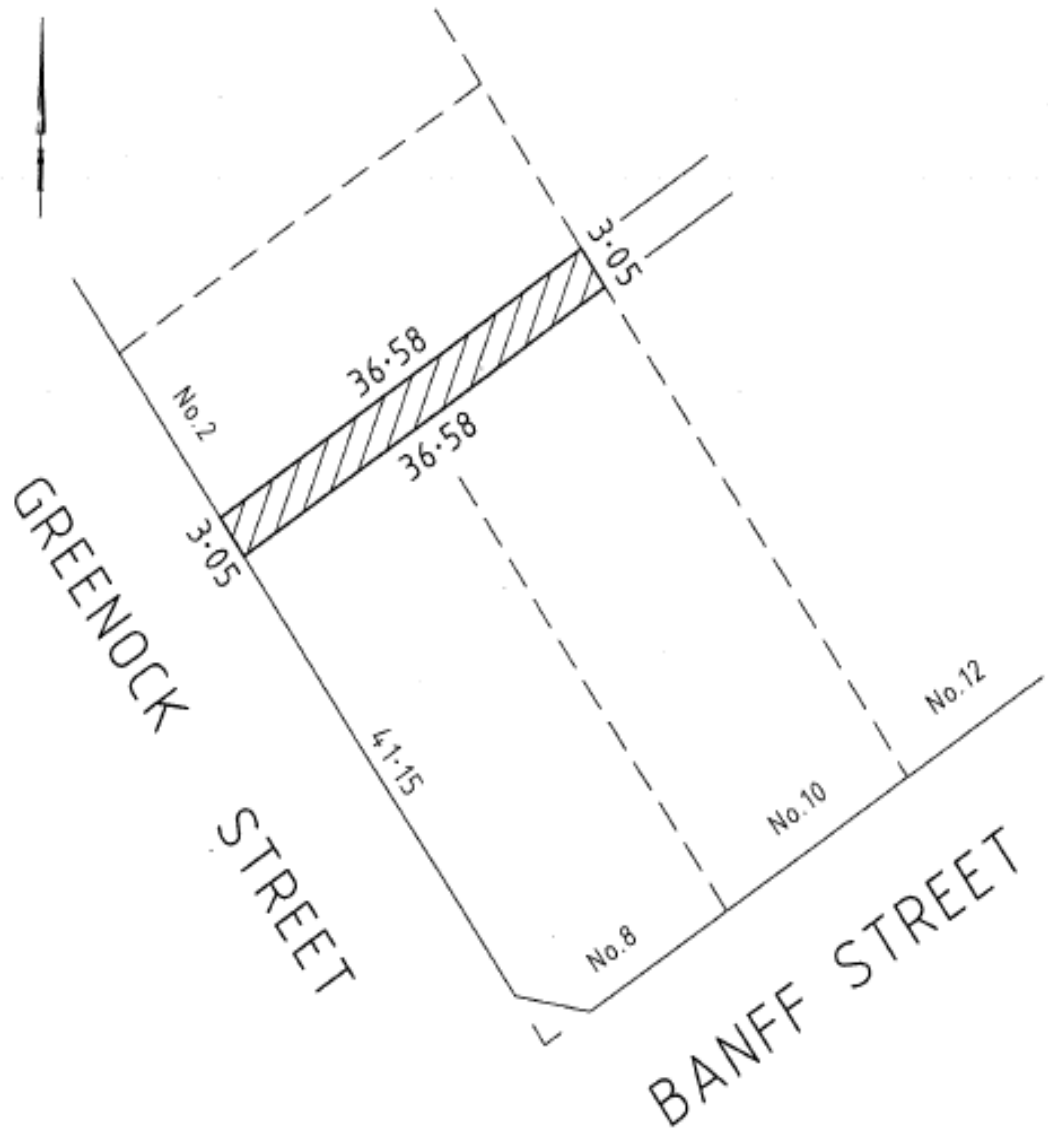



Appendix C



Appendix D

TITLE PLAN		EDITION 1	TP955714T	
LOCATION OF LAND PARISH KEELBUNDODRA CROWN PORTION 14 (PART) LAST PLAN REFERENCE LP10498 DEPTH LIMITATION DOES NOT APPLY TITLE REFERENCE VOL 5622 FDL 243 MGA CO-ORDINATES E 325 710 (APPROX CENTRE OF LAND IN PLAN) N 5 025 160 ZONE 55		WARNING THIS PLAN REPRESENTS AN EXPECTED DIVISION OF LAND. ANY ONE LOT MAY NOT HAVE BEEN CREATED. CHECK THE LDT/PLAN INDEX FOR CURRENT INFORMATION. NOTATIONS THIS PLAN IS NOT BASED ON SURVEY		
EASEMENT INFORMATION				
LEGEND E- ENCUMBERING EASEMENT OR CONDITION IN CROWN GRANT IN THE NATURE OF AN EASEMENT OR OTHER ENCUMBRANCE A- APPURTENANT EASEMENT R- ENCUMBERING EASEMENT (ROAD)				
EASEMENT REFERENCE	PURPOSE	WIDTH (METRES)	ORIGIN	LAND BENEFITED/IN FAVOUR OF
E-1	AS PROVIDED FOR IN SEC 207C LGA 1989	3.05	SEC 207C LGA 1989	YARRA VALLEY WATER LTD
E-1	AS PROVIDED FOR IN SEC 207C LGA 1989	3.05	SEC 207C LGA 1989	CITY OF DAREBIN
SCALE 1:400			LICENSED SURVEYOR DAVID JOHN MONAHAN SIGNATURE _____ DATE / /	FILE NO : LGD DEALING CODE : LGA
SHEET 1 OF 1 SHEETS ORIGINAL SHEET SIZE A3 BARKER MONAHAN <small>A.C.N. 885 354 805 SURVEYORS, DEVELOPMENT AND LOCAL GOVERNMENT CONSULTANTS 581 GILBERT ROAD, PRESTON 3072 P.O. BOX 2546 REGENT WEST 3072 TELEPHONE 9478 6133 FAX 9470 5189 EMAIL info@barkermonahan.com.au</small>		REF 11243B COMPUTER FILE 12638TP01.DWG	VERSION 01 DATE 31/07/2015	