

PLAN UNDER SECTION 24A OF THE SUBDIVISION ACT 1988	EDITION 1	PS633073R
---------------------------------------------------------------	------------------	------------------

LOCATION OF LAND

PARISH JIKA JIKA

CROWN PORTION 147 (PART)

TITLE REFERENCES VOL.3466 FOL.015
VOL.4103 FOL.493
VOL.5844 FOL.661

LAST PLAN REFERENCE LOT 5 ON TP831144C

POSTAL ADDRESS 20 PELLEW STREET,
(AT TIME OF SUBDIVISION) RESERVOIR 3073

MGA CO-ORDINATES E 323 765 ZONE 55
(APPROX. CENTROID) N 5 823 026 GOA 94

COUNCIL NAME: DAREBIN CITY COUNCIL

VESTING OF ROADS AND/OR RESERVES	
IDENTIFIER	COUNCIL/BODY/PERSON
NIL	NIL

PURPOSE OF PLAN
TO VEST THE DRAINAGE & SEWERAGE RESERVE ON LP8679, SHOWN AS LOT 1 ON THIS PLAN, IN THE DAREBIN CITY COUNCIL.

REMOVAL BY THE DAREBIN CITY COUNCIL OF THE RESERVE STATUS FROM THE DRAINAGE & SEWERAGE RESERVE ON LP8679, SHOWN AS LOT 1 ON THIS PLAN.

GROUNDS FOR REMOVAL
AS DIRECTED IN DAREBIN CITY COUNCIL PLANNING PERMIT No.

NOTATIONS

DEPTH LIMITATION DOES NOT APPLY

SURVEY: THIS PLAN IS NOT BASED ON SURVEY

THIS SURVEY HAS NOT BEEN CONNECTED TO PERMANENT MARKS AND IS NOT IN A PROCLAIMED SURVEY AREA.

EASEMENT INFORMATION

LEGEND E- ENCUMBERING EASEMENT OR CONDITION IN CROWN GRANT IN THE NATURE OF AN EASEMENT OR OTHER ENCUMBRANCE
A- APPURTENANT EASEMENT R- ENCUMBERING EASEMENT (ROAD)

EASEMENT REFERENCE	PURPOSE	WIDTH (METRES)	ORIGIN	LAND BENEFITED/IN FAVOUR OF
E-1	DRAINAGE AND SEWERAGE	1-83	LP8679	LOTS ON LP8679
E-1	ANY EASEMENTS	1-83	LP8679	UNSPECIFIED
E-1	DRAINAGE	1-83	THIS PLAN	DAREBIN CITY COUNCIL

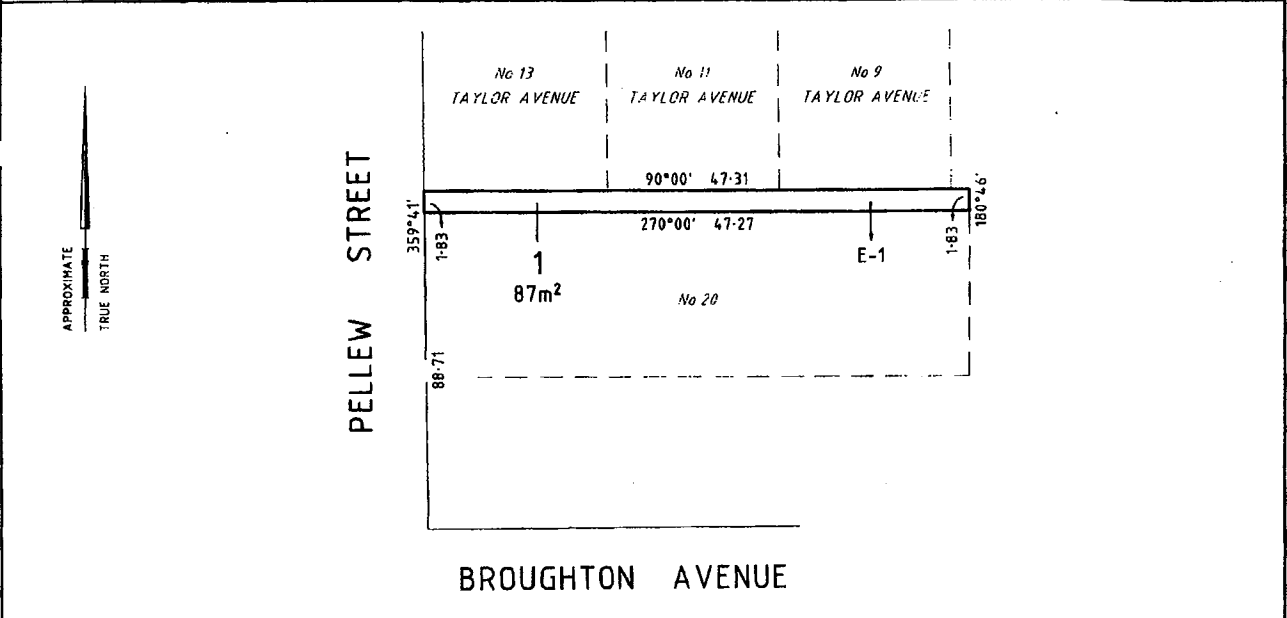

REF 13697 COMPUTER FILE: 3697-24A.DWG	VERSION 01 DATE 15/11/2016	SCALE 1:400	 LENGTHS ARE IN METRES	ORIGINAL SHEET SIZE A3	SHEET 1 OF 1 SHEET
BARKER MONAHAN <small>A.C.N. 005 394 065 SURVEYORS, DEVELOPMENT AND LOCAL GOVERNMENT CONSULTANTS 581 GILBERT ROAD, PRESTON 3072 P.O. BOX 2546 REGENT WEST 3072 TELEPHONE 9478 4133 FAX 9470 5189 EMAIL: survey@barkermonahan.com.au</small>		DAVID JOHN MONAHAN, VERSION 01			