

TITLE PLAN	EDITION 1	TP967917L
-------------------	------------------	------------------

LOCATION OF LAND

PARISH KEELBUNDORA
TOWNSHIP -
SECTION -
CROWN ALLOTMENT -
CROWN PORTION 13 (PART)
LAST PLAN REFERENCE LP8482
DEPTH LIMITATION DOES NOT APPLY
TITLE REFERENCE VOL.12085 FOL.364
MGA CO-ORDINATES E 323 410
(APPROX. CENTRE OF LAND IN PLAN) N 5 825 700 ZONE 55

WARNING
THIS PLAN REPRESENTS AN EXPECTED DIVISION OF LAND.
ANY ONE LOT MAY NOT HAVE BEEN CREATED.
CHECK THE LOT/PLAN INDEX FOR CURRENT INFORMATION.

NOTATIONS
THIS PLAN IS NOT BASED ON SURVEY.

EASEMENT INFORMATION

LEGEND E- ENCUMBERING EASEMENT OR CONDITION IN CROWN GRANT IN THE NATURE OF AN EASEMENT OR OTHER ENCUMBRANCE
A- APPURTENANT EASEMENT R- ENCUMBERING EASEMENT (ROAD)

EASEMENT REFERENCE	PURPOSE	WIDTH (METRES)	ORIGIN	LAND BENEFITED/IN FAVOUR OF
E-1	AS PROVIDED FOR IN SEC.207C LGA 1989	SEE DIAGRAM	SEC.207C LGA 1989	YARRA VALLEY WATER

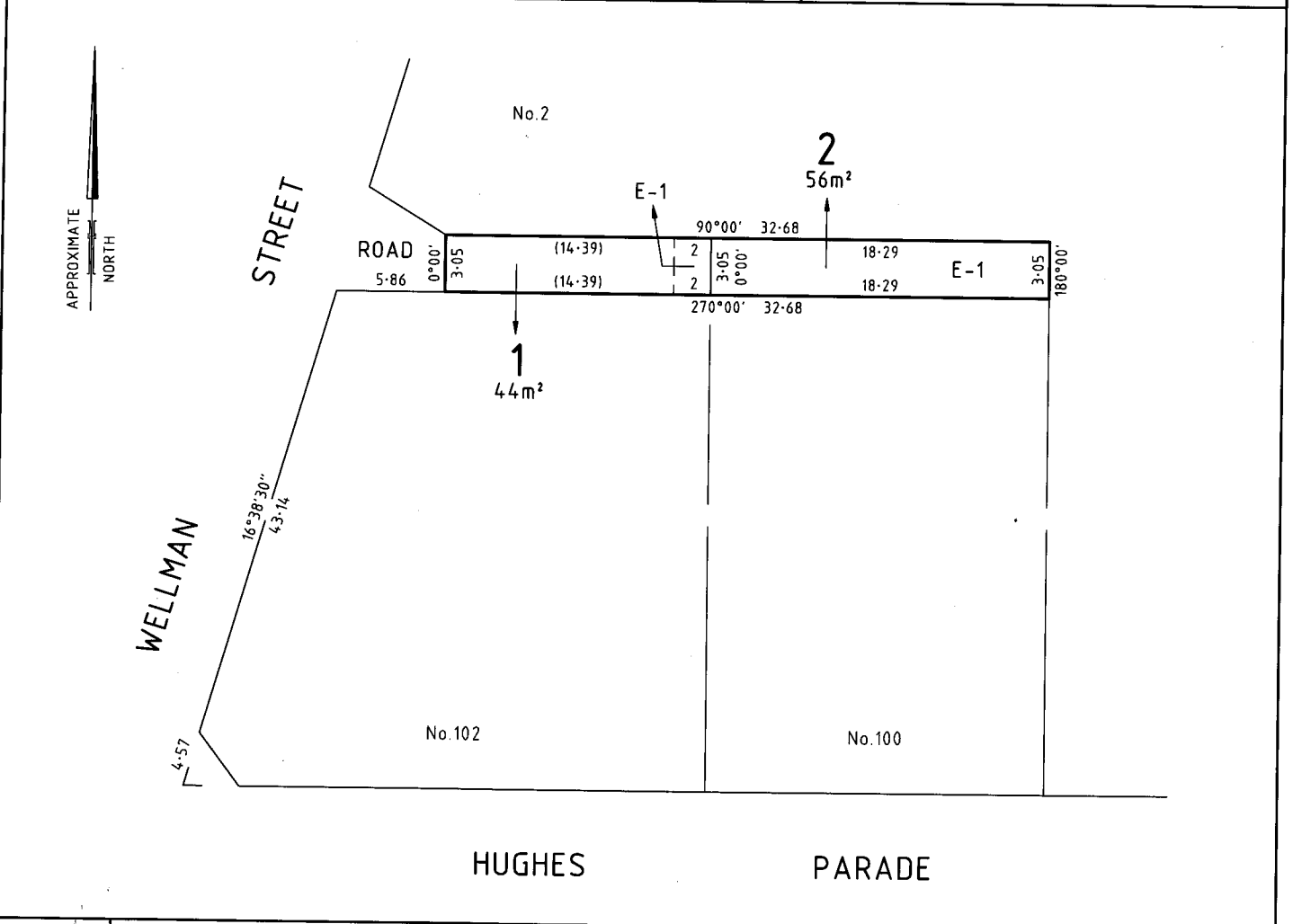

SCALE 1:250	0 2 4 6 8 10 LENGTHS ARE IN METRES	LICENSED SURVEYOR ANDREW CLINTON SMITH	FILE NO : LGD
SHEET 1 OF 1 SHEET ORIGINAL SHEET SIZE: A3		SIGNATURE _____ DATE / /	DEALING CODE : LGA
BARKER MONAHAN A DIVISION OF TERRAIN CONSULTING GROUP PTY LTD SURVEYORS, DEVELOPMENT AND LOCAL GOVERNMENT CONSULTANTS 581 GILBERT ROAD, PRESTON 3072 P.O. BOX 2546 REGENT WEST 3072 TELEPHONE 9478 6133 FAX 9470 5189 EMAIL: survey@barkermonahan.com.au		REF. 194.04	VERSION 01
		COMPUTER FILE: 19404TP.DWG	DATE: 09/10/2019